



OAK LAWN COMMUNITY HIGH SCHOOL

INCOMING FRESHMEN CURRICULUM NIGHT
WELCOME CLASS OF 2029!
JANUARY 2025

Dr. Lauren May

Principal

OUR MISSION:

As a diverse and inclusive 21st-Century school, our mission is to graduate students prepared for future success through a safe, supportive, and intellectually challenging environment committed to the values of **Spartan PRIDE.**

Tonight's Agenda

- General Information about OLCHS
- Overview of Course Selection Process
- Elective Session Breakouts (refer to map)

Bell Schedule

Most
freshmen
take
6
courses

Daily Bell Schedule (Monday/Tuesday/Thursday/Friday)		
Period	Start	End
0	6:50	7:40
1	8:32	9:20
2	9:24	10:12
3 (Spartan Plus)	10:16	10:56
4	11:00	11:24
5	11:28	11:52
6	11:56	12:20
7	12:24	12:48
8	12:52	1:16
9	1:20	2:08
10	2:12	3:00

Support For All Students

- Spartan Plus Period
- Reading Strategies and Algebra Support Courses
- Student Intervention Coordinator
- Counselor & Social Worker Groups
- National Honor Society Tutoring Program
- Parental Programs/Parent University
- English as Second Language Resources
- Special Education Resources

TITLE I

OLCHS PARTICIPATES IN TITLE I, PART A PROGRAMS

Title I, Part A requires:

Parents receive a description and explanation of the school's curriculum.

Parents are informed about the academic assessment used to measure children's progress.

Parents receive information about the proficiency levels students are expected to meet.

Parents have a right to be involved in Title I, Part A programs.

Parents will receive timely notice if their child has been assigned or has been taught for four (4) or more consecutive weeks by a teacher who is not highly qualified. Currently, all OLCHS teachers are highly qualified within the meaning of the term in section 200.56 of the Title I Final Regulations (67 Fed. Reg. 71710, December 2, 2002)



Apple Distinguished School

Oak Lawn Community High School

Recognized for continuous innovation in learning, teaching, and the school environment.

2021–2024



Distinguished School

Recognized by Apple as a distinguished school for continuous innovation in learning, teaching, and the school environment.

www.olchs.org

Oak Lawn Community High School

Empowered teachers who inspire empowered learners



Who We Are

1800 students

120 faculty members

Public

Grades 9-12

Apple Products
in Use at OLCHS

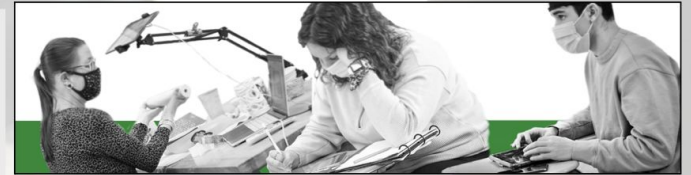

Today

Oak Lawn Community High School envisions a school that develops future-ready citizens who:

- respect and embrace high standards of learning,
- strive to be responsible, engaged individuals of strong character,
- partner with our diverse communities,
- possess the skills and knowledge to innovate in the global economy.

Simply put, after four years, Spartans will be prepared for whatever is it they want to do when they graduate.

OLCHS had to re-imagine learning due to the global pandemic, and we were ready. Staff

ON FRIDAYS WE WEAR GREEN



Clubs & Activities

Alliance

Anime and SciFi

Arabic Honor Society

Bible Club

Chess Team

Creative Writing Club

Esports

Drama/Crew

Fishing Team

Gaming Club

Frosh-Soph Class Advisory Board

International Club

Jazz Band

Junior Class Advisory Board

Mathletes Team

Muslim Student Association

National Honor Society

National Art Honor Society

OLAS

Peer Tutors

Photojournalism Club

SADD (Students Against Destructive Decisions)

Scholastic Bowl Team

Senior Class Advisory Board

Shield (Yearbook)

Spanish Honor Society

Spartanite (Newspaper)

Spartan Screammers

Spartan Sisterhood

Speech Team

STEM Club

Student Council

Student Helpers

Visual Arts



Athletic Programs

- Football
- Golf
- Cheerleading
- Dance
- Girls Cross Country
- Boys Cross Country
- Boys Soccer
- Girls Swim/Dive
- Girls Tennis
- Girls Volleyball
- Boys Basketball
- Girls Basketball



Don't forget your physical!

- Boys Swim/Dive
- Wrestling
- Boys Bowling
- Girls Bowling
- Girls Badminton
- Boys Baseball
- Girls Soccer
- Girls Softball
- Boys Tennis
- Boys Track
- Girls Track
- Boys Volleyball

Oak Lawn Community High School



Activity Night for Incoming Freshmen

January 24, 2025 6pm - 8pm

Sponsored by the OLCHS Parent-Teacher-Student Association (PTSA)

- Swimming
- Video Gaming
- Basketball
- Snacks
- Badminton
- School Clubs
- Volleyball
- School Athletics



Free
t-shirts!

Visit the OLCHS PTSA Facebook page for more information:
www.facebook.com/OLCHSPTSA

School Administration



Dr. Lauren May
Principal
Overall School
Program



Mr. Marcus Wargin
Assistant Principal
Student Activities
Communication



Mr. Michael Sunquist
Assistant Principal
Student Services
Summer School

Students with IEPs and EL Services



Mr. Nick Novak
Special Education Coordinator



Mr. Michael Shehan
EL Director



Mr. Michael Bielski
Science



Mrs. Kristin Kuchyt
Social Studies



Mr. Chris Newton
Mathematics



Dr. Semaj Coleman
Fine Arts

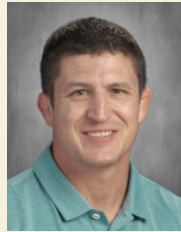

Mr. Dave Early
PE, Drivers, Health



Mrs. Erika Johnson
English



Mr. Michael Shehan
World Languages/EL



Mrs. Jennifer Faro
Career & Technical
Education



Mrs. Jamie Atkus
Special Education



PLANNING FOR SUCCESS

MR. MICHAEL SUNQUIST

ASSISTANT PRINCIPAL

708-741-5625

MSUNQUIST@OLCHS.ORG

Your Packets

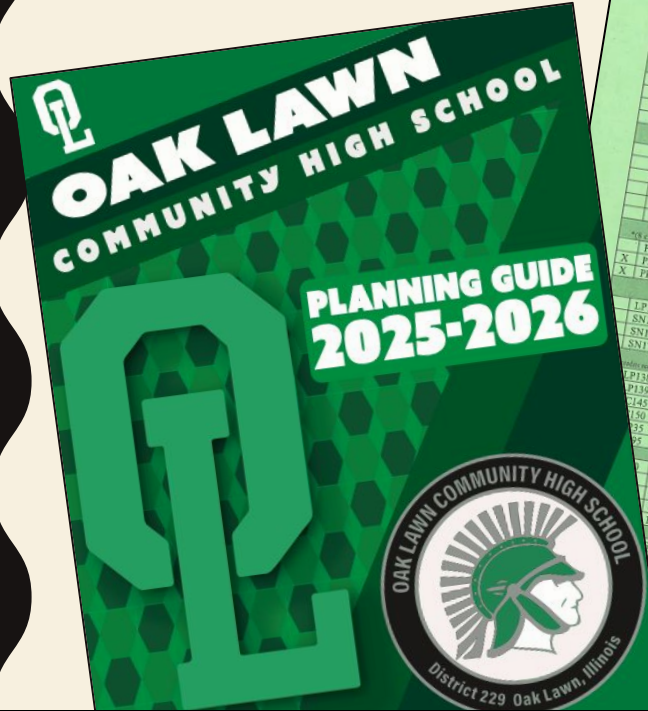

OLCHS FRESHMAN COURSE SELECTION 2025-2026

Student ID#: _____ Date of Birth: _____

DIRECTIONS: Please place an X in the first column to designate your course selections. Remember to choose classes/12 credits. Required courses are indicated with an asterisk (*).

X	Course Code	Course Title	Credits
ENGLISH			
	LP101	LRP English I	2.0
	EG116	Reading Strategies	2.0
	EG110	English I	2.0
	EG175	English I Honors	2.0
MATHEMATICS			
	LP106	LRP Algebra I	2.0
	MH125	Algebra Support	2.0
	MH130	Algebra I	2.0
	MH175	Algebra I Honors	2.0
	MH195	AP Computer Science Principles	2.0
	MH273	Geometry Honors	2.0
PHYSICAL EDUCATION			
	PH115	PEPEL	1.0
X	PH130	PE I	1.0
X	PH340	Health	1.0
SCIENCE			
	LP105	LRP Biology RS (Reading Support)	2.0
	SN102	Biology RS (Reading Support)	2.0
	SN140	Biology	2.0
	SN175	Biology Honors	2.0
SOCIAL STUDIES			
	LP138	LRP World History I	2.0
	PL139	LRP World History II	2.0
	PL145	World History II	2.0
	PL150	World History I	2.0
	PL155	Geography	1.0
	PL165	AP Human Geography	1.0
	PL170	ART*	1.0
BUSINESS EDUCATION*			
	PL180	Exploring Drawing and Multimedia	1.0
	PL185	Clay Construction I	2.0
	PL190	Clay Construction II	2.0
	PL195	Photography I	1.0
	PL200	Photography II	1.0
	PL205	Microsoft Office Applications	1.0
	PL210	Mobile Apps Development	1.0
	PL215	Entrepreneurship	2.0
	PL220	Design	1.0
FINANCIAL TECHNOLOGY*			
	PL225	Foundations of Technology	1.0
	PL230	Automotive Essentials	1.0
	PL235	Woods I	1.0
	PL240	Graphic Design I	1.0
	PL245	Graphic Design II	1.0
	PL250	Electricity/Electronics I	1.0
	PL255	Electricity/Electronics II	1.0
	PL260	PLTW: Intro to Engineering Design	1.0
MUSIC*			
	MS140	Piano I	2.0
	MS141	Piano II	2.0
	MS111	Guitar I	1.0
	MS112	Guitar II	1.0
	MS250	Musical Technology	1.0
	MS120	Bass Ensemble	1.0
	MS121	Treble Choir	1.0
	MS110	Concert Band	2.0

Student Name: _____
OLCHS ID# _____

CLASS OF 2029 STUDENT PLACEMENT

OLCHS works collaboratively with 8th grade teachers to determine placements for incoming freshmen based on MAP scores and middle school academic performance. All placements have been reviewed and agreed upon by teachers at OLCHS and Simmons*.

For more details, please refer to the Placement Guidelines also included in your packet. If you have questions or concerns, please reach out to the appropriate administrator listed below.

English Placement:
English Department Chair Mrs. Erika Johnson ejohnson@olchs.org

Math Placement:
Math Department Chair Mr. Chris Newton cnewton@olchs.org

Science Placement:
Science Department Chair Mr. Michael Bielski mbielski@olchs.org

PLEASE NOTE: Families of students with IEPs will NOT have to sign up or attend a registration conference. Your courses are selected by the IEP team at your student's annual review/transition meeting. An OLCHS staff member will be attending those conferences in late January/early February.

If you have other questions about the course selection or registration process, please call the school at 708-428-5200.

*Simmons placements will be confirmed before Course Selection on February 5, 2025.



Core course placements were determined using 8th grade teacher input, prior achievement, & MAP scores as available.

CLASS OF 2029

Graduation Requirement: Service Learning

Students must complete 25 hours of approved community service before graduation.

- Pre-Approved Sites
- Information Online

Contact person:

Mrs. Kelly Kenny

kkenny@olchs.org



CLASS OF 2029

Graduation Requirements

(SEE PAGE 4 IN THE PLANNING GUIDE)

44 Credits are required for graduation

(Each passed semester course = 1 credit)

- 8 credits of English
- 4 credits of Science
- 6 credits of Mathematics
- 5 credits of Social Studies
- 8 credits of Physical Education (PE/Health/Driver's ED)
- 1 credit of Consumer Education
- 4 credits in any of the following departments:

Art, Business, Family and Consumer Sciences, Foreign Language, Industrial Technology, or Music



CLASS OF 2029

Typical Freshman Schedule and Four-Year Plan

FRESHMAN YEAR SEMESTER 1	FRESHMAN YEAR SEMESTER 2
ENGLISH 1	ENGLISH 1
WORLD HISTORY 1 OR READING	WORLD HISTORY 2 OR READING
ALGEBRA 1	ALGEBRA 1
BIOLOGY	BIOLOGY
PE 1	HEALTH
ELECTIVE	ELECTIVE

(See page 5 in the Planning Guide)

Preparing To Select Courses

- How many courses?
- Placement recommendations
- Elective offerings
- Future plans (Career Pathways)



CLASS OF 2029

Selecting Elective Courses

For graduation, students need four (4) credits in any of the following departments: Art, Business, Foreign Language, Family and Consumer Sciences, Music, or Industrial Technology

What should we be thinking about?

- Tonight's Elective Sessions
- Career Pathways & Interests
- Course Descriptions

CLASS OF 2029

Selecting Electives By Career Cluster

(Also see the Spartan Guide to Career Pathways - see page 4)

OAK LAWN COMMUNITY HIGH SCHOOL



We believe students should select elective courses that connect with their career interests and post-secondary goals. To better identify possible career interests, we recommend that your child completes a Career Cluster Interest Inventory to identify their top Career Clusters. Career Clusters are nationally recognized groups of occupations that require similar knowledge and skills. Students, parents, and educators can use Career Clusters to help focus education plans towards obtaining the necessary knowledge, competencies, and training for success in a particular career pathway. Your child will work with a school counselor to develop this education plan.

To take the Career Cluster Interest Inventory, go to <https://tinurl.com/OLCHSCUSTER>.



To explore OLCHS Electives available to Freshmen that connect to your child's top Career Cluster, use the chart below and the Course Descriptions on the back of this form.

Dual credit courses are indicated by*

-Geography -Arabic, French, Spanish	-Electricity & Electronics III* -Woods I -Arabic, French, Spanish	-Extreme Art -Exploring Drawing & Multimedia -Graphic Design I -Clay Construction -Band, Choir, Guitar, Piano, Music Techn -Arabic, French, Spanish	-Entrepreneurship -Arabic, French, Spanish	-Intro to Child Development & Culinary Arts -Arabic, French, Spanish	-Microsoft Office -Arabic, French, Spanish	-Geography -AP Human Geography -Arabic, French, Spanish	-Arabic, French, Spanish
-Culinary Arts I & II -Arabic, French, Spanish	-Intro to Child Development & Culinary Arts -Arabic, French, Spanish	-Google IT! -Mobile Apps I -Web Design -Arabic, French, Spanish	-Arabic, French, Spanish	-PLTW 1 - IED -Electricity & Electronics III* -Arabic, French, Spanish	-Entrepreneurship -Arabic, French, Spanish	-AP Computer Science Principles -Mobile Apps I -PLTW 1 - IED -Arabic, French, Spanish	-Automotive Essentials -Arabic, French, Spanish

SELECT THREE AREAS TO VISIT

****THREE 10-MINUTE SESSIONS**

****5 MINUTE TRAVEL TIME BETWEEN SESSIONS**

Tonight's Elective Session Tours

ELECTIVE COURSE BREAKOUT SESSION LOCATIONS

- | | |
|--|--|
| A. Stairs | F. Room 11 – MUSIC |
| B. Room 234 or 240 (second floor) – ART | G. Dance Studio – WORLD LANGUAGES |
| C. Elevator | H. Room 107 – BUSINESS |
| D. Room 220/222 (second floor) – INDUSTRIAL TECH | J. Room 113 – DUAL CREDIT and CAREER EXPLORATION |
| E. Rooms 155 & 157 – FAMILY/CONSUMER SCIENCE | |

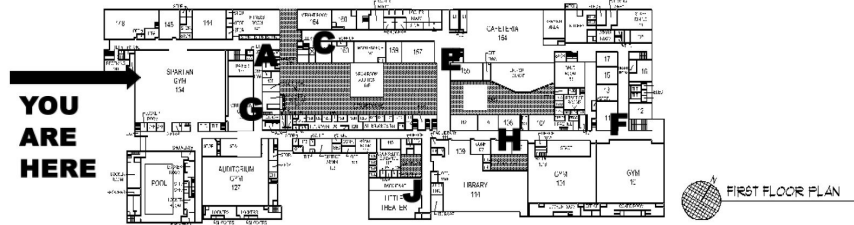
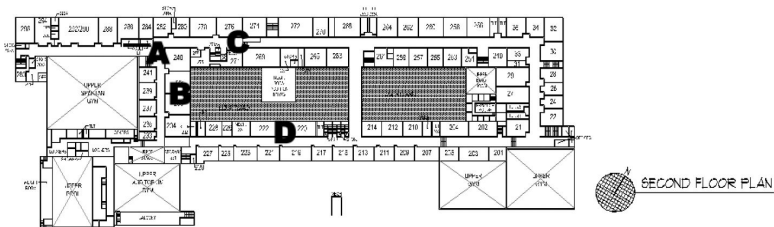

Course Selection Process

FRESHMAN COURSE SELECTION
INDIVIDUAL PHONE OR IN-PERSON MEETINGS

WEDNESDAY, FEBRUARY 5, 2025, 3:30-8:00pm

- Review elective choices and complete **Green** Course Selection Sheet from packet
- Placements for English, math, science and world languages are pre-determined (see **Pink** Placement Sheet)
- Copies of birth certificate, Student Information Sheets, home language surveys, and payments for summer school can be dropped off at the school between 8am and 4pm, sent by mail, or collected on February 5th.

COMPLETING THE COURSE SELECTION FORM

OLCHS FRESHMAN COURSE SELECTION 2025-2026

Student Name: _____ Student ID#: _____
 Counselor: _____ Date of Birth: _____

DIRECTIONS: Please place an X in the first column to designate your course selections. Remember to choose 6 classes/12 credits. Required courses are indicated with an asterisk (*).

X	Course Code	Course Title	Credits
	ENGLISH		
	*(1 credit required for graduation)		
	LP101	LRP English I	2.0
	EG116	Reading Strategies	2.0
	EG130	English I	2.0
	FG175	English I Honors	2.0
	MATHEMATICS		
	*(2 credits required for graduation)		
	LP106	LRP Algebra I	2.0
	MH125	Algebra Support	2.0
	MH130	Algebra I	2.0
	MH175	Algebra I Honors	2.0
	MH185	AP Computer Science Principles	2.0
	MP175	Geometry Honors	2.0
	PHYSICAL EDUCATION		
	*(1 credit required for graduation & 1 credit of 1 course required for graduation)		
	PH115	PE/OPH	1.0
X	PH130	PE I	1.0
X	PH140	Health	1.0
	SCIENCE		
	*(1 credit required for graduation)		
	LP105	LRP Biology BS (Reading Support)	2.0
	SN102	Biology BS (Reading Support)	2.0
	SN130	Biology	2.0
	SN175	Biology Honors	2.0
	SOCIAL STUDIES		
	*(1 credit required for graduation)		
	LP138	LRP World History I	1.0
	LP139	LRP World History II	1.0
	SC145	World History I	1.0
	SC150	World History II	1.0
	SC255	Geography	1.0
	SC195	AP Human Geography	1.0
	ART*		
	ATI20	Extreme Art	1.0
	ATI30	Exploring Drawing and Multimedia	2.0
	ATI40	Clay Construction I	1.0
	ATI41	Clay Construction II	1.0
	ATI50	Photography I	1.0
	BUSINESS EDUCATION*		
	BS131	Google IT	1.0
	BS137	Microsoft Office Applications	1.0
	BS140	Mobile Apps Development	2.0
	BS141	Entrepreneurship	1.0
	BS160	Web Design	1.0
	PE		
	EL100	ESL Foundations	2.0
	EL115	ESL Reading	2.0
	EL130	ESL English I	2.0
	EL332	Bilingual Algebra/Algebra Support - Arabic	4.0
	EL Combined		
	EL622	Bilingual Health - Arabic	1.0
	EL631	Bilingual Physical Science - Arabic	2.0
	EL721	Bilingual World History - Arabic	2.0
	EL122	Bilingual Consumer - Arabic	1.0
	EL530	Bilingual Algebra/Algebra Support - Spanish	4.0
	EL Spanish		
	EL622	Bilingual Health - Spanish	1.0
	EL641	Bilingual Physical Science - Spanish	2.0
	EL732	Bilingual US History - Spanish	2.0
	EL122	Bilingual Consumer - Spanish	1.0
	FAMILY AND CONSUMER SCIENCES*		
	FS134	Intro to Child Dev & Culinary Arts	1.0
	FS252	Culinary Arts I	1.0
	FS253	Culinary Arts 2	1.0
	FS254	Baking and Pastry	1.0
	FS269	Technology for Teaching & Learning	1.0
	WORLD LANGUAGES*		
	FG130	French I	2.0
	FG230	French II	2.0
	FG140	Spanish I	2.0
	FG141	Spanish for Heritage Speakers I	2.0
	FG193	Spanish for Heritage Speakers I-H	2.0
	FG240	Spanish II	2.0
	FG285	Spanish II Honors	2.0
	FG150	Arabic I	2.0
	FG151	Arabic for Heritage Speakers I	2.0
	FG196	Arabic for Heritage Speakers I Honors	2.0
	FG150	Arabic II	2.0
	FG151	Arabic for Heritage Speakers II	2.0
	FG196	Arabic for Heritage Speakers II Honors	2.0
	INDUSTRIAL TECHNOLOGY*		
	ID190	Fundamentals of Technology	1.0
	ID230	Automotive Essentials	1.0
	ID260	Woods I	1.0
	ID242	Graphic Design I	1.0
	ID243	Graphic Design II	1.0
	ID295	Electricity, Electronics I	1.0
	ID241	Electricity, Electronics II	1.0
	ID500	PLTW Intro to Engineering Design	2.0
	MUSIC*		
	MS140	Piano I	1.0
	MS141	Piano II	1.0
	MS115	Guitar I	1.0
	MS215	Guitar II	1.0
	MS150	Music Technology	1.0
	MS120	Band Ensemble	2.0
	MS121	Tribe Choir	2.0
	MS110	Concert Band	2.0
	MS110	Symphonic Band	2.0
	MS111	Percussion Ensemble	2.0

OLCHS FRESHMAN COURSE SELECTION 2025-2026

2025-2026 COURSE SELECTIONS

SUBJECT	COURSE Semester One	COURSE Semester Two
Lunch	Lunch	Lunch
English		
Elective		
Math		
Elective		
PE/Health	Health	PE
Science		

ALTERNATIVE COURSE CHOICES REQUIRED TO COMPLETE THIS SECTION.

- _____
- _____
- _____

I understand that I may not be able to change any course(s) after March 15, 2025.

Student Signature: _____ Phone: _____
 Parent Signature: _____ Phone: _____

ADDITIONAL CHOICES:

ZERO HOUR OPTION	
Semester 1	Semester 2
_____	_____

Enroll in a 7th course during Zero hour. Zero hour class will meet from 6:50 a.m. - 7:45 a.m. The course offered during zero hour will be determined at the end of registration. There is no fee.

SUMMER SCHOOL COURSE	
First Session (6:50-9:00 a.m.) June 4 - June 15 *	Second Session (9:15-10:30 a.m.) June 30 - July 17
Freedom Academy Must be recommended 200 FEE	

*Dates are tentative based on school's use of Emergency/Storm Days.

Completed forms will be used during
 Freshman Course Selection Sessions on Feb. 5th

COMPLETING THE COURSE SELECTION FORM

2025-2026 COURSE SELECTIONS		
SUBJECT	COURSE Semester One	COURSE Semester Two
Lunch	Lunch	Lunch
English		
Elective		
Math		
Elective		
PE/Health	Health	PE
Science		

ALTERNATIVE COURSE CHOICES REQUIRED TO COMPLETE THIS

Oak Lawn Community High School -- Class of 2029 Placement Guidelines for the 2025-2026 School Year

In addition to standardized test scores, OLCHS will include additional criteria for placement into freshman-level classes. This is an opportunity for students to enrich their learning experience and be placed into the most appropriate course in each subject area. Students are encouraged to take the most challenging coursework that they are prepared for and will receive appropriate support regardless of placement.

The Class of 2029 Placement Process includes student and family input in the selection of classes. In order to do so, we will consider the following information when determining placement:

1. Middle School Teacher Recommendation
2. Standardized Test Scores and/or Writing Samples
3. Eighth Grade Grades in Progress (or Standards Met)
4. Student Elective Interest
5. Student/Family Enrollment Requests

All course placements were determined collaboratively with OLHMS and Simmons. Spanish and Arabic placements are in progress.

COMPLETING THE COURSE SELECTION FORM

I understand that I may not be able to change any course(s) after March 15, 2025.

Student Signature: _____ Phone: _____

Parent Signature: _____ Phone: _____

ADDITIONAL CHOICES:

Enroll in a 7th course during Zero hour. Zero hour class will meet from 6:50 a.m. – 7:40 a.m. The course offered during zero hour will be determined at the end of registration. There is no fee.

ZERO HOUR OPTION	
Semester 1	Semester 2

Enroll in this course during Summer School. Summer School courses have an enrollment fee of \$150.00 per semester unless this is a repeated course. Attach payment to this form.

SUMMER SCHOOL COURSE	
First Session (\$150.00 fee.) June 4 – June 25 *	Second Session (\$150.00 fee.) June 30 – July 17*
Freshman Academy Must be recommended NO FEE	

*Dates are tentative based on school's use of Emergency/Snow Days.

Families can select an additional seventh course (zero hour) as well as register for summer school during Freshman Course Selection Individual Meetings on Feb. 5th.

Summer School

- World History I and/or World History II (graduation requirements)
- Foundations of Technology (elective)
- Freshman Academy (invite only)

Classes Held Monday to Thursday

8:00am – 1:25pm

Semester 1: June 4 - June 25

Semester 2: June 30 - July 17



No class on Fridays or on June 19

Special Education

- High School Transition/Annual Review Meetings
 - Input from your current teachers
 - Help with selection of coursework
 - Setting goals and outcomes



After February 5th

- Student choices will be entered into our scheduling system.
- You will receive communications over the summer from the school about the final registration process.
 - OLCHS will begin the residency verification process in early 2025 by attempting to electronically verify each family's residence
 - Students can access their schedule in Skyward when final registration is completed (Summer).



STUDENT/PARENT ENGAGEMENT AND COMMUNICATIONS

MR. MARCUS WARGIN

ASSISTANT PRINCIPAL

708-741-5613

MWARGIN@OLCHS.ORG

Skyward Family Access



At OLCHS all communication will come from information in **OLCHS** Skyward. If you need to update or correct any phone or email information please contact Adrienne Gannon at 708/741-5626 or agannon@olchs.org

STAY CONNECTED

The screenshot shows the website for Oak Lawn Community High School. At the top, there is a navigation bar with a language selector, a 'SAFE & HELP' logo, social media icons for Facebook, YouTube, Instagram, and a search icon, and a 'Quick Links' dropdown menu. Below this is a green header with the school's logo and name. A secondary navigation bar contains links for District 229, Academics, Activities, Athletics, Students, Parents, and Staff. The main content area features a photo of a girls' volleyball team in pink uniforms. At the bottom, there is a row of six service tiles: Alumni, Canvas, Calendar, Contact Us, Incoming Students, and Skyward Family/Student. A 'Quick Links' dropdown menu is also shown on the right side of the page.

Select Language

SAFE & HELP

Quick Links

OAK LAWN COMMUNITY HIGH SCHOOL

District 229 Academics Activities Athletics Students **Parents** Staff

Alumni Canvas **Calendar** Contact Us **Incoming Students** Skyward Family/Student

Quick Links

- Calendar
- Skyward Family/Student
- Staff Directory
- Student Services

STAY CONNECTED



Canvas
Parent
Access



Jostens -
Yearbook &
Class Jewelry



Media Center



Oak Leaflet
Newsletter



OLCHS Web
Store



Skyward
Family
Access



Spartan Spirit
Store



The
Spartanite |
School
Newspaper



Student
Announcements

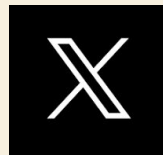

2025-26 Registration Steps

- Select Courses on Wednesday, Feb 5th
- Prove Residency before May 23rd
- Complete Skyward Verification in July
- Schedules Available August 1st

